



staron[®]

Solid Surfaces

LOTTE ADVANCED MATERIALS

LOTTE ADVANCED MATERIALS, a creator of high-quality materials and refined sensibilities.

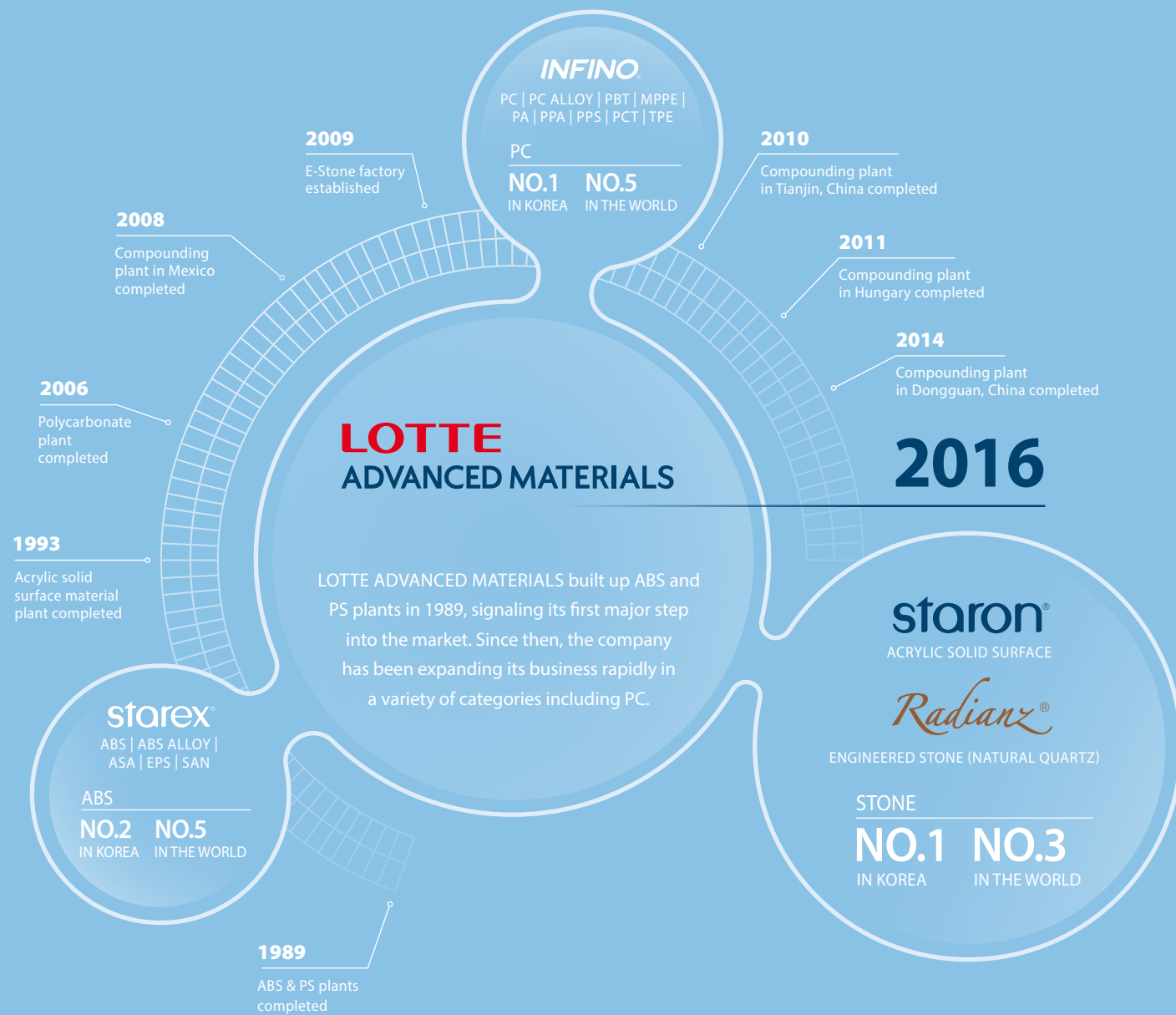

LOTTE ADVANCED MATERIALS, formerly Cheil Industries, established in 1954 as the founding parent company of the Samsung Group, kicked off its chemical business as part of its portfolio expansion strategy. In 1992, the company started its solid surface business and in 2009 made a foray into manufacturing of engineered stone (quartz surfaces) in a move to strengthen its business portfolio further.

In May 2016, the company was renamed as LOTTE ADVANCED MATERIALS, a move forward toward achieving a greater vision of becoming a global supplier of high-quality, decorative surfacing materials.

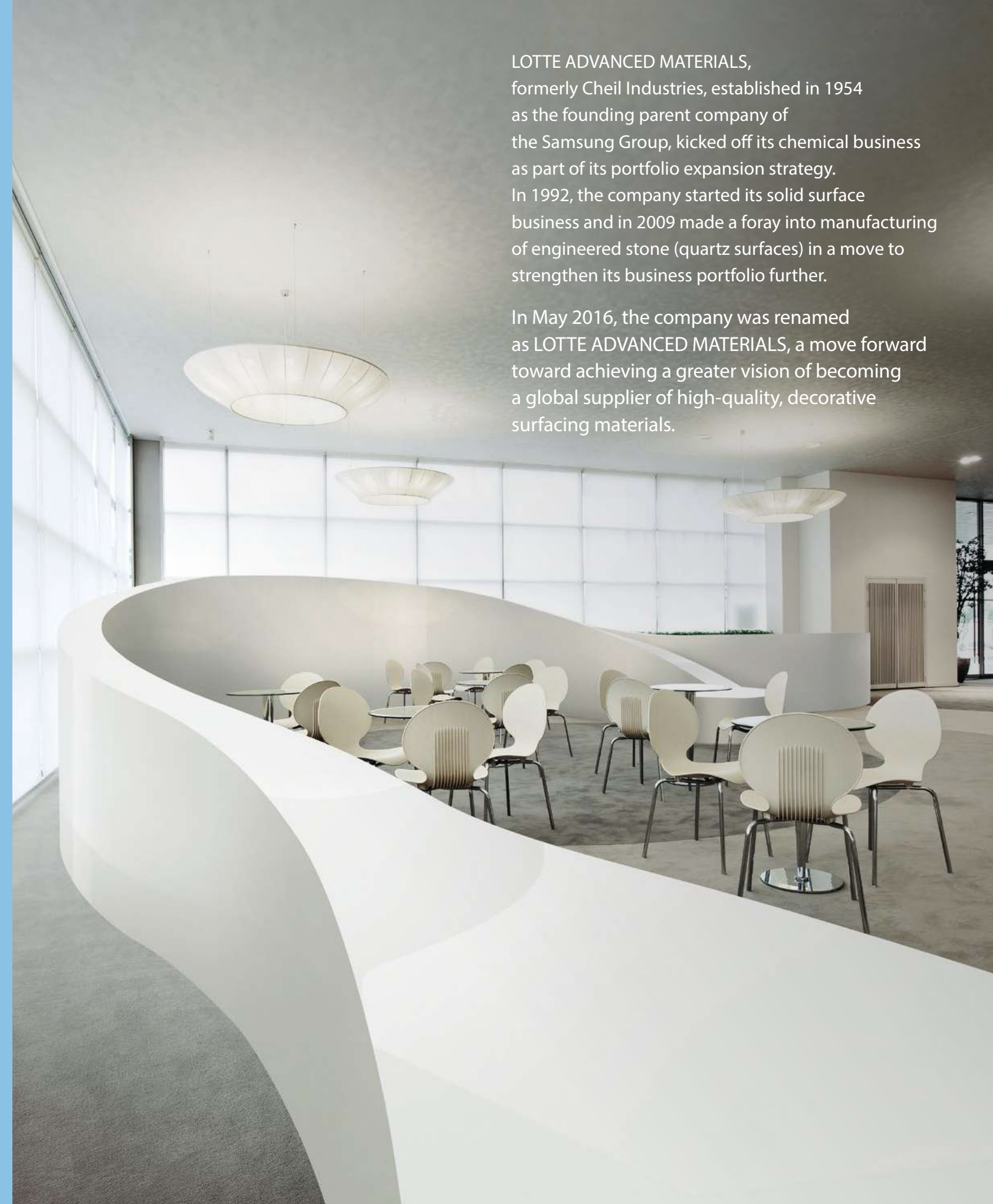

STRETCH YOUR IMAGINATION TO EXPERIENCE THE POSSIBILITIES WITH STARON.

WHY STARON ?

Staron, a high-performance acrylic solid surface material, is known for excellent workability and easy maintenance. Staron's internal composition is uniform and non-porous; its textures are elegant and stylish. Offering a wide variety of patterns and colors, Staron is a durable surface for creative interior design of commercial and residential spaces. Staron brands include the Tempest series of semi translucent surfaces, and the Supreme collection, known for its natural patterns.



DEPENDABLE PERFORMANCE

- Innovation meets superior standard
- Offering higher performance to suit commercial environments
- Homogenous material which allows the surface to be easily restored



KEEPING THE SURFACE HYGIENIC

- Designed with end-users in mind, your environment can be protected from the growth of bacteria or fungi
- Resistant to harsh chemicals
- Easy to maintain



DIMENSIONAL FLEXIBILITY

- Bringing another layer of depth & sophistication
- Free forming of 3 dimensional representation is possible
- Excellent workability & precise expression of various design



INFINITE RANGE OF COLORS

- From natural to vivid palette tones, Staron® offers over 150 colors
- Including Tempest®, the world's first "jewel-like" solid-surface material
- Ongoing collaboration with color trend experts guides us in the development of relevant and emerging color choices and designs.



SEAMLESS

- Create a variety of smooth forms that are works of art
- These subtle features increase the value of the completed design



ILLUMINATING THE ENVIRONMENT

- Excellent for backlighting to create various images and text related effects
- Brightness and transparency can be adjusted by modifying and varying the thickness of the material to allow transmission from a low-energy light source.



GLOBAL NETWORK

- Operating regional branch offices around the world in addition to global distribution networks



EXCELLENT QUALITY

- High quality control policy and a commercial 10-year warranty
- Certified eco-friendly, Staron® contributes to a comfortable and safe environment

NEW COLORS

• To view new colors in detail, please visit www.staron.com



Beige Granite
VB172

Sonoma
FS143

Bronzestar
FB154

Quarry Ridge
QR278

Collina Mirage
PM879

Collina Chai
PC829

Aspen Cliff
AC652

Cotton White
VC110

Aspen Alder
AA625

Sanded Meadow
SM465

Pebble Tea Rose
PT845

Pebble Boulder
PB852

Sanded Chestnut
SC457

Urban Grey
VU127

Crystal Sundance
NS955

Morning Sky
VM114

Aspen Concrete
AC629

Sanded Taupe
ST486

COMMERCIAL & PUBLIC SPACES

01

Workspace,
Dongdaemun
Design Plaza & Park,
Korea, Designed by
Zaha Hadid



02

Display Furniture,
Retail Shop,
Switzerland,
Designed by
Zaha Hadid



03

Exhibition Hall,
Institute of
Human Resources
Development,
Korea



04

Display Furniture,
Wall Covering,
Stewart Weitzman
Shoes Shop,
Greece



05

Counter Top,
Table, Cafeteria,
Lotteria, Korea

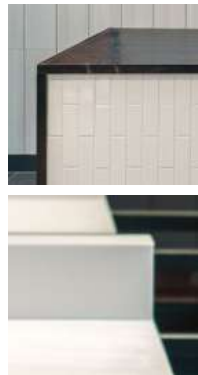

07

Media Façade,
Kumho Art Hall,
Yonsei Univ.,
Korea



06

Information Desk,
Dongdaemun
Design Plaza & Park,
Korea, Designed by
Zaha Hadid



08

Tabletop,
Art Wall,
Season's Table
Restaurant,
Korea

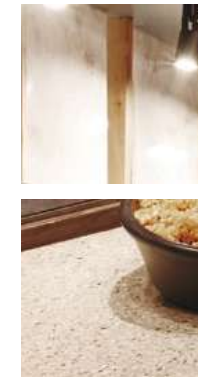

09

Reception Desk,
Schaffhauser
Kantonalbank,
Switzerland,
Designed by
Gehri Architects



10

Display Furniture,
Fashion Shop,
Korea



11

Countertop,
Artwall,
Restaurant,
France



12

Table, Interior Deco,
Sushi bar, Cyprus

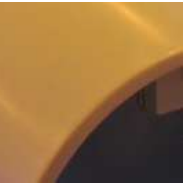

13

Lighting Box,
BIBIGO Restaurant,
Korea



HEALTHCARE & HOSPITALITY

01

Wall Covering,
Furniture,
Dental Hygiene
School, Swiss,
Designed by
Bern Smile



 SEAMLESS INSTALLATIONS

 EASY TO MAINTAIN

 NON-POROUS

 EASY TO CLEAN

 EXCELLENT DURABILITY

 HOMOGENOUS

 RESISTANT TO STAINS AND CHEMICALS

 SUPERIOR QUALITY

 VERSATILE DESIGN

 SUSTAINABLE

02

Furniture,
Art Wall,
Marriott
Renaissance
Barcelona Fira
Hotel, Spain



03

Furniture,
Wall Covering,
Hypnotique Spa,
Italy, designed by
Simone Micheli

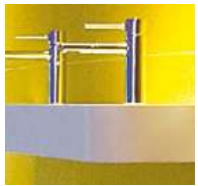

04

Wall Covering,
Wash Bowl,
Tabletop,
Sheraton Grande
Walkerhill Hotel,
Korea





Supreme,
Ocean view
VO171

01

Kitchen
Countertop,
Korea



02

Kitchen
Countertop,
Interior Furniture,
Australia,
Designed by
Darren James

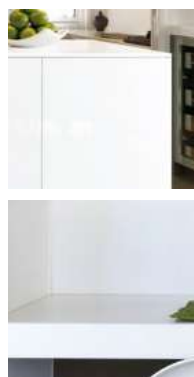

04

Kitchen Countertop,
Jakarta Design
Center, Showroom,
Indonesia



03

Kitchen
Countertop,
England



05

Kitchen Countertop,
Australia,
Designed by
Lenka Jankovcova



06

Wash Bowl,
Bathtub, Korea



07

Wash Bowl,
Bathtub, Korea



08

Tabletop,
Australia



09

Kitchen
Countertop,
Euro Cucina,
Italy



10

Wall Covering,
Hong Kong
Pacific Palace,
China



CREATIVE WORKS

01

Hedgehog Sofa,
2014, London
100% Design

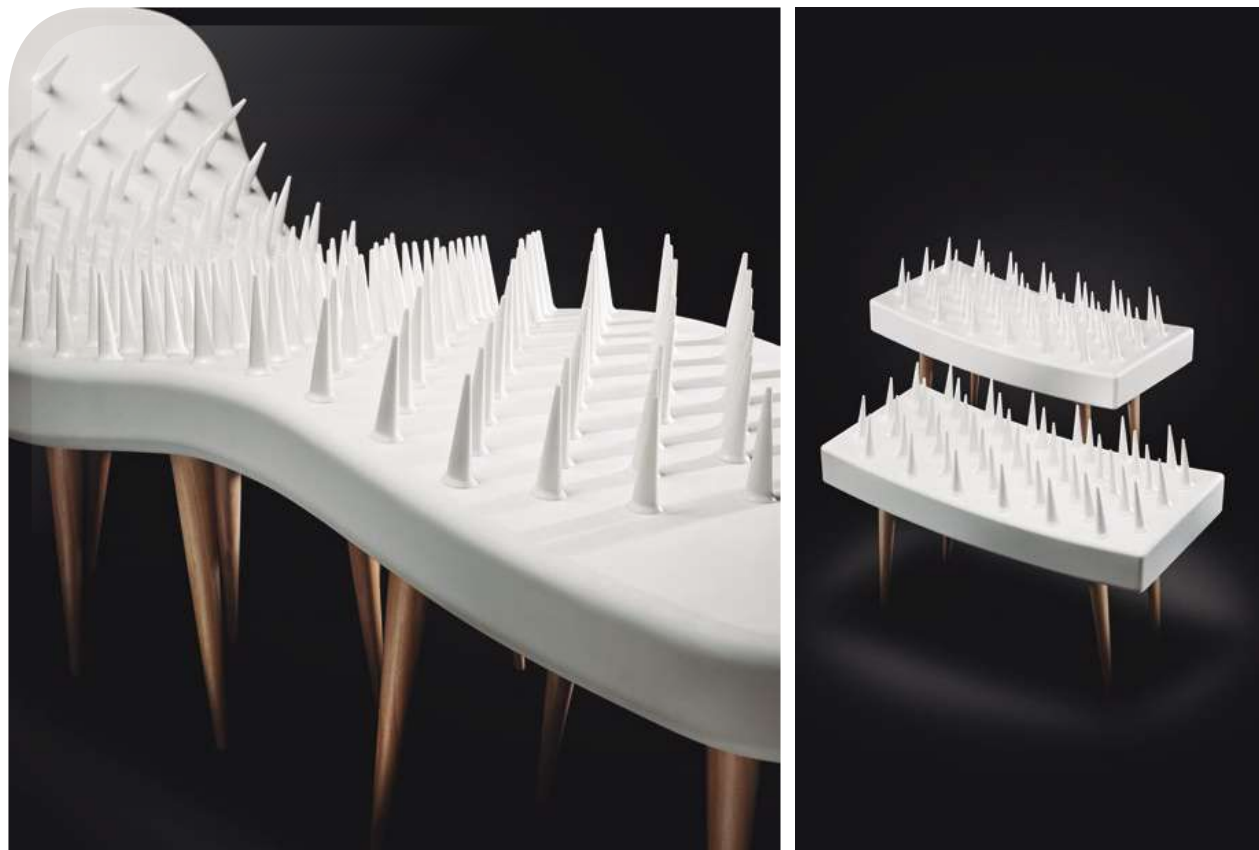

02

Owl Speaker,
2014, London
100% Design



04

Zebra Table,
2014, London
100% Design



03

Humpback Whale
Island Kitchen,
2014, London
100% Design



05

Killer Whale
Kitchen Island,
2014, London
100% Design





DESIGNER'S CHOICE

LOBBYS AND PUBLIC SPACES

The random, directional pattern of Supreme Collection colors add visual texture in a material that is smooth to the touch and thermo-formable for optimum design flexibility.

<p>1</p> <p>Magnolia VM143</p> <p>RECOMMEND MATERIAL BOARD</p>	<p>2</p> <p>Natural Bridge VN144</p> <p>RECOMMEND MATERIAL BOARD</p>	<p>3</p> <p>Dandelion VD175</p> <p>RECOMMEND MATERIAL BOARD</p>
---	---	--



DESIGNER'S CHOICE

RESTAURANTS

Staron is an ideal, color-through surfacing material in hospitality and restaurant settings.

The Supreme Collection's ocean-like patterns add a relaxed, yet sophisticated, design aesthetic that is durable and renewable.

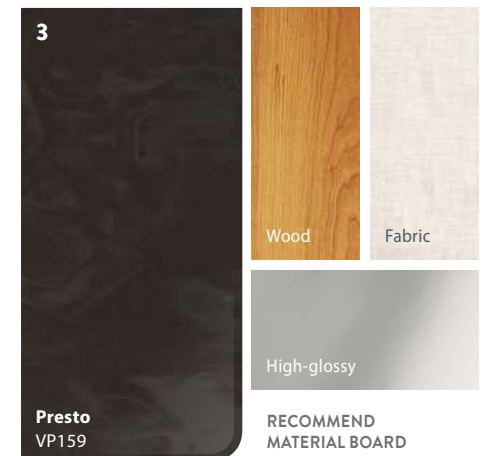
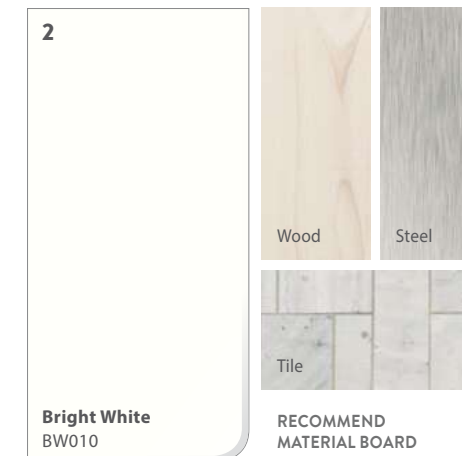
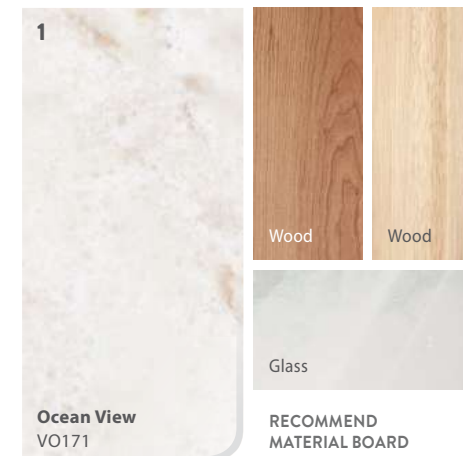



DESIGNER'S CHOICE

HEALTHCARE

Staron surfaces provide a seamless and ultra-hygienic design element to healthcare, spas and wellness interiors. Pure and neutral solid-colors, such as Staron Bright White, add a modern, contemporary look and feel.

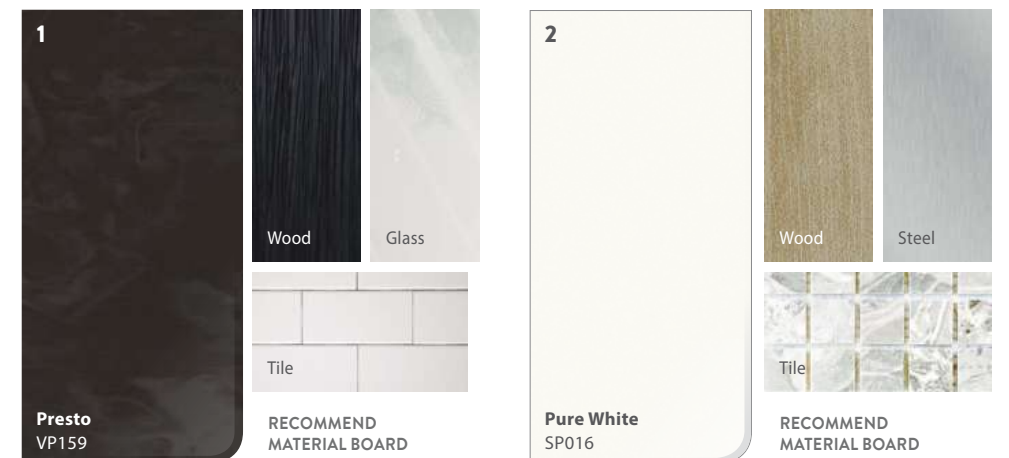

COLORS OF STARON

Supreme™



Morning Sky VM114

NEW



Cotton White VC110

NEW

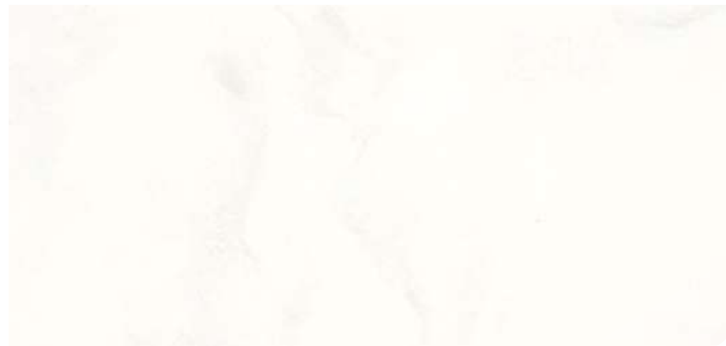

Delphi VD111



Cloudbank VC118



Natural Bridge VN144



Dandelion VD175



Loam VL155



Presto VP159

Truly Unique, the Supreme™ collection

The Supreme™ collection features a natural, rhythmic pattern and delivers the next generation of high-performance, premium surfaces for commercial spaces and discerning residential interiors.



Beige Granite VB172

NEW



Urban Grey VU127

NEW



Dawn VD126



Magnolia VM143



Ocean View VO171



Pastoral VP177

- To view new colors in greater detail, please visit www.staron.com
- These colors may require extra care and maintenance; consult with your Staron specialist for the best use of these colors.

SOLID



SANDED

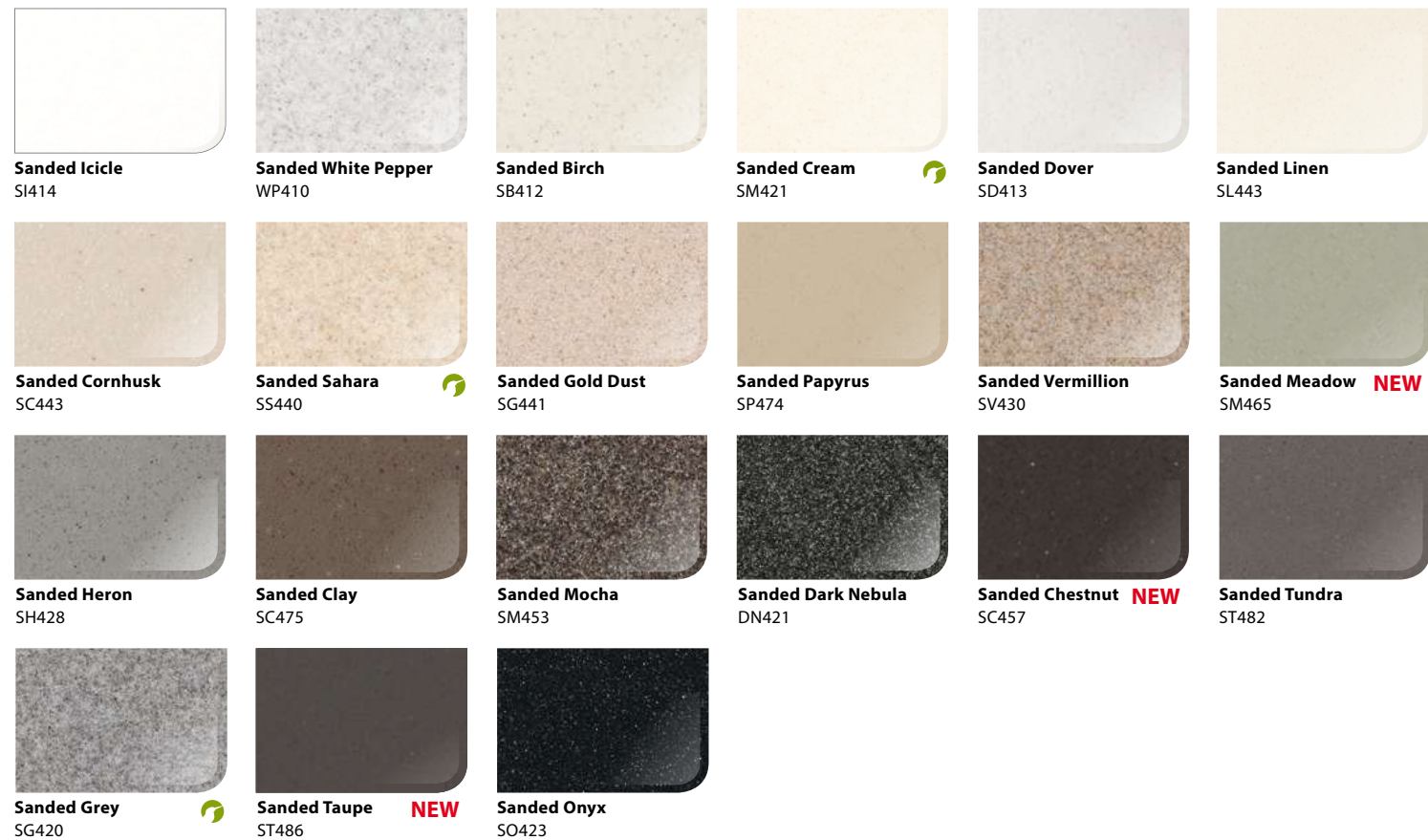

ASPEN

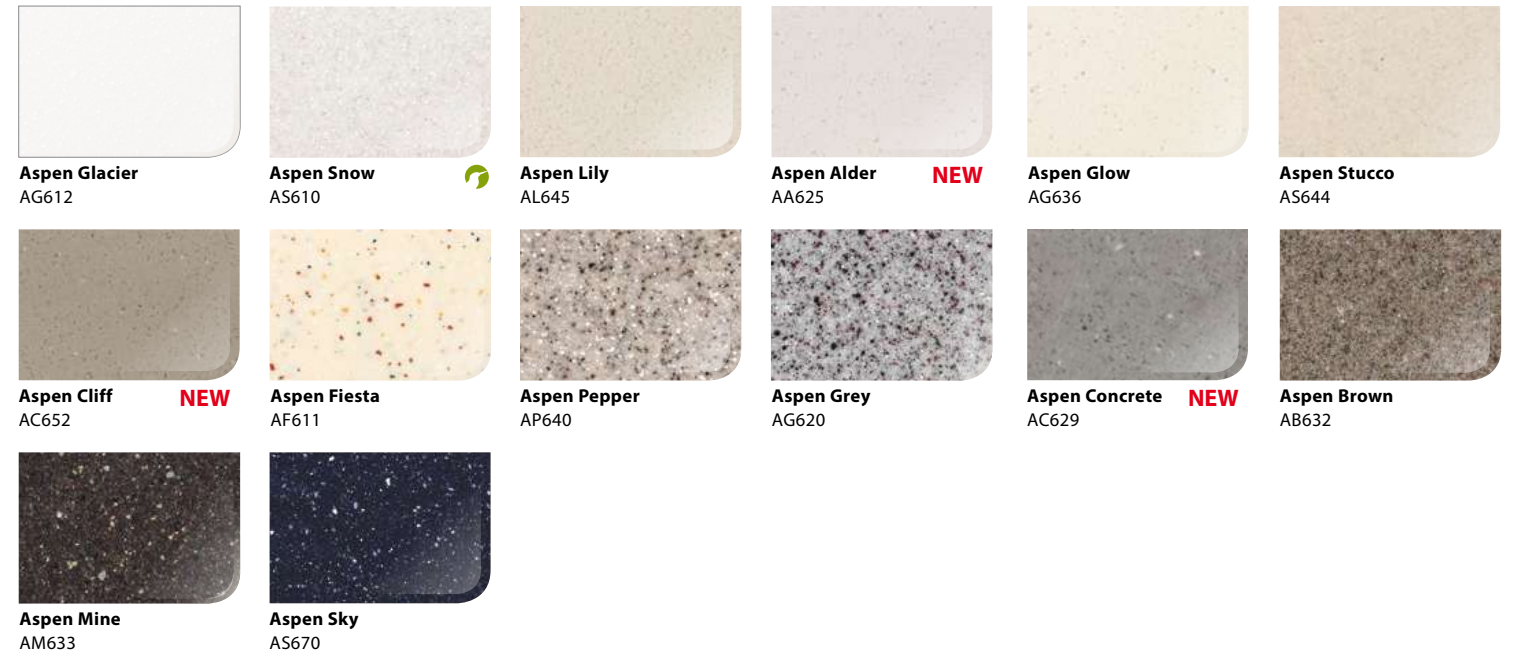

PEBBLE

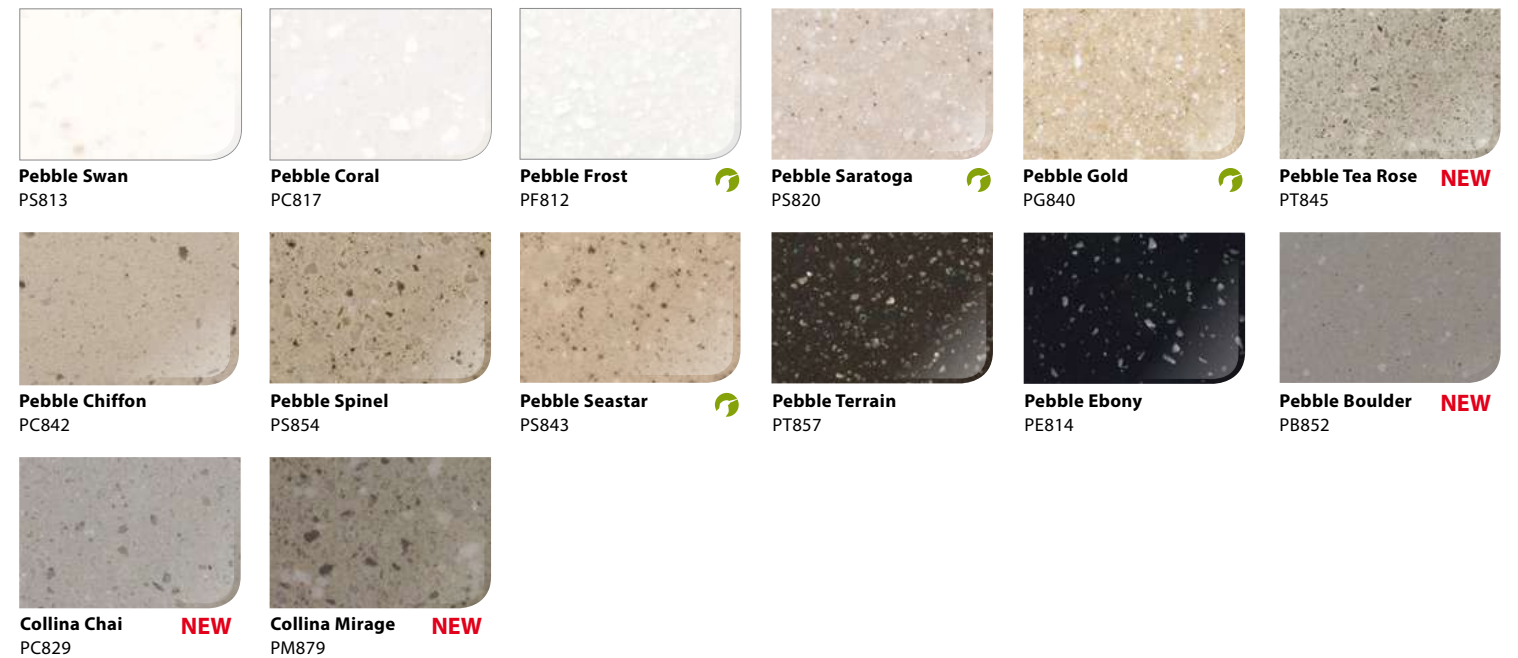

Eco-friendly Materials, Staron

Printed representation of colors may vary from actual samples. Please review actual sample prior to selection.

Staron recycled content series.

QUARRY



Quarry Oyster
TO310

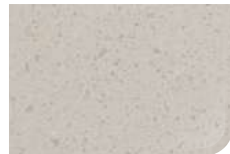

Quarry Ridge
QR278 **NEW**



Quarry Starred
QS287

CRYSTAL



Crystal Sundance
NS955 **NEW**

METALLIC



Metallic Yukon
EY510



Metallic Satingold
ES558



Metallic Sleeksilver
ES581



Metallic Galaxy
EG595

tempest®



Peak
FP100



Polar
FP111

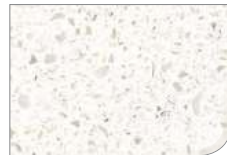

Meteor
FM111



Sonoma
FS143 **NEW**



Horizon
FH114



Genesis
FG174



Bronzestar
FB154 **NEW**



Igneous
FI187



Caraway
FC155



Coffee Bean
FC158

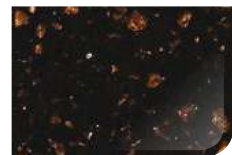

Shimmer
FR148

SINK & BOWLS

ADA Compliant

LAVATORY SINKS / BASINS

A3201

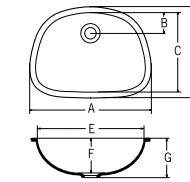

- A 20-3/8" (517mm)
- B 3-3/8" (86mm)
- C 13-5/8" (346mm)
- D 15-3/16" (386mm)
- E 18-13/16" (477mm)
- F 5-1/2" (140mm)
- G 6-3/16" (157mm)

A3211

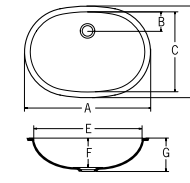

- A 21-9/16" (548mm)
- B 3-3/8" (86mm)
- C 14" (356mm)
- D 15-9/16" (396mm)
- E 20" (508mm)
- F 6-1/8" (156mm)
- G 6-13/16" (173mm)

A3181

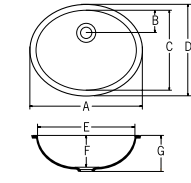

- A 18-3/16" (462mm)
- B 3-11/16" (94mm)
- C 13-1/4" (336mm)
- D 14-13/16" (376mm)
- E 16-5/8" (422mm)
- F 5-1/2" (139mm)
- G 6-1/8" (156mm)

- Sink & Bowls internal specifications are noted below.
- LOTTE ADVANCED MATERIALS does not guarantee the color match of Sink & Bowls and sheets.
- Staron Sink & Bowls are at best implemented in a product of these three colors:

Color Options



Bright White BW010



Pearl SP011



Ivory SI040

Design Options

An integral sink will improve the efficiency and hygienic qualities of a kitchen or bath area and, particularly, interior commercial applications. Staron all-acrylic sinks and bowls are installed in combination with Staron sheet materials as part of a continuous surface featuring imperceptible seams for a perfect, uninterrupted fit. That also means there are no gaps or crevices for bacteria or mold to accumulate and grow. Whichever style you choose, Staron's non-porous, hygienic surfaces will always be easy to clean and maintain. Choose from three coordinated sink color options from a collection of ten, popular models

KITCHEN / UTILITY SINKS

A2311

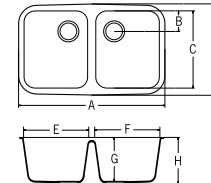

- A 31-1/4" (794mm)
- B 4-15/16" (110mm)
- C 16-9/16" (421mm)
- D 18-15/16" (481mm)
- E 13-11/16" (348mm)
- F 13-11/16" (348mm)
- G 9-1/4" (235mm)
- H 9-13/16" (250mm)

A2321

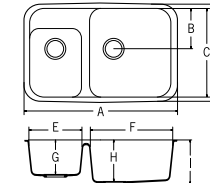

- A 32-13/16" (834mm)
- B 8-13/16" (244mm)
- C 19-1/4" (488mm)
- D 21-9/16" (548mm)
- E 11-5/16" (287mm)
- F 17-9/16" (446mm)
- G 7-1/2" (191mm)
- H 9" (229mm)
- I 9-5/8" (244mm)

A2341

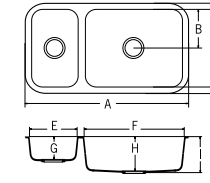

- A 34-7/8" (886mm)
- B 8-3/8" (213mm)
- C 16-3/4" (426mm)
- D 19-1/8" (486mm)
- E 10" (254mm)
- F 21" (533mm)
- G 5" (127mm)
- H 7-1/2" (191mm)
- I 8-1/16" (206mm)

A1121

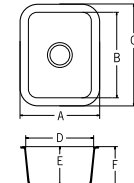

- A 12-13/16" (326mm)
- B 14" (356mm)
- C 16-3/8" (416mm)
- D 10-3/8" (266mm)
- E 6-1/2" (165mm)
- F 7-1/16" (180mm)

A1131

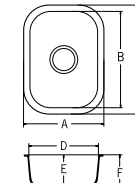

- A 13-7/16" (341mm)
- B 15-3/4" (400mm)
- C 18-1/8" (460mm)
- D 11-1/16" (281mm)
- E 5-1/4" (133mm)
- F 5-7/8" (148mm)

A1181

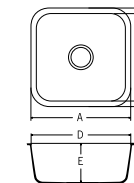

- A 18-1/8" (460mm)
- B 15-3/4" (400mm)
- C 18-1/8" (460mm)
- D 15-3/4" (400mm)
- E 8-3/16" (208mm)
- F 8-7/8" (225mm)

A1231

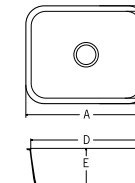

- A 23-5/16" (592mm)
- B 16-5/8" (422mm)
- C 19" (482mm)
- D 20-15/16" (532mm)
- E 7-3/8" (187mm)
- F 7-15/16" (202mm)

MOUNTING OPTIONS

Seam mount

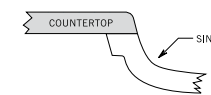

Under mount

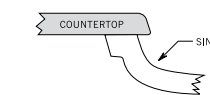

Angled mount

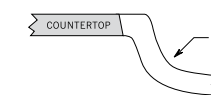

PERFORMANCE PROPERTIES

The information contained herein is provided by LOTTE ADVANCED MATERIALS Co., Ltd. and subsidiaries and affiliates for information purposes only and should be used by individuals with technical experience and knowledge in the area. LOTTE ADVANCED MATERIALS does not make any representation or warranties of the usefulness or expected result of the information, and does not assume any responsibility whatsoever related to the use of the information. Exclusion of the implied warranties may not apply in certain jurisdictions.

PROPERTIES	TYPICAL RESULTS	TEST PROCEDURE
Tensile strength	6,000 psi	ASTM D 638
Tensile modulus	600,000 psi	ASTM D 638
Flexural strength	10,000 psi	ASTM D 790
Flexural modulus	1,000,000 psi	ASTM D 790
Elongation	0.5%	ASTM D 638
Hardness	92 Rockwell "M" Scale 65 Barcol impressor	ASTM D 785 ASTM D 2583
Thermal expansion	2.0x1.0 ⁻⁵ in/in F°	ASTM D 696
Gloss (60 Gardner)	Between 5-20	NEMA LD-3
Color stability	No change-200hrs	NEMA LD-3
Stain resistance	Pass Rating 41	ANSIZ 124
Abrasion resistance	Pass	ANSIZ 124
Boiling water surface resistance	No effect	NEMA LD-3
High temperature resistance	No effect	NEMA LD-3
IZON Impact resistance (Notched)	0.28ft. lbf/in	ASTM D 256
Ball drop 1/2" (12.3 mm) sheet	144"w/1/2lb ball No failure	NEMA LD-3
Fungi and Bacterial resistance	No growth	ASTM G 21, G22
Specific gravity Solid colors Patterened colors	1.72 1.69	ASTM D 792
Water absorption	0.04%, (1/2", 24hrs) 0.11%, (1/8", 24hrs)	ASTM D 570
Flammability Flame spread Smoke density	Class A/Class 1 10 10	UBC 8-1 ASTM E 84 ASTM E 84
Radiant heat resistance	No visual effect	NEMA LD-3
Toxicity	84.4g (solid Color) 81.8g (Patterned Color)	Pittsburgh test protocol (LC50 Test)

PRODUCT DIMENSIONS

COLLECTION

Supreme, Solid,
Sanded, Aspen,
Pebble, Quarry
Mosaic, Metallic,
Tempest



THICKNESS	WIDTH	LENGTH
mm	mm	mm
12 (1/2in)	760 (30in)	3,680 (145in)

COLLECTION

Solid, Sanded,
Aspen



THICKNESS	WIDTH	LENGTH
mm	mm	mm
6 (1/4in)	760 (30in)	2,500 (98in)

- 6mm (1/4") thickness sheet is not recommended for horizontal application.
- If there is a specific dimension or size that is required for a particular project, please consult with the local installer.

STARON® 10-YEAR LIMITED WARRANTY

The 10-Year warranty applies to Staron, Tempest and Supreme Collection products that have been installed in an interior, commercial-use or residential application. For more details, please consult with your Staron products distributor, or visit www.staron.com

DISCLAIMER

The information contained herein is provided by LOTTE ADVANCED MATERIALS Co., Ltd. and LOTTE ADVANCED MATERIALS USA Inc. for information purposes only and should be used by individuals with technical experience and knowledge in the area. LOTTE ADVANCED MATERIALS Co., Ltd. does not make any representation or warranties of the usefulness or expected result of the information, and does not assume any responsibility whatsoever related to the use of the information. Exclusion of the implied warranties may not apply in certain jurisdictions. LOTTE ADVANCED MATERIALS USA Inc. is a subsidiary of LOTTE ADVANCED MATERIALS Co., Ltd.

LOTTE ADVANCED MATERIALS THAILAND CO., LTD.

16th Floor, Empire Tower, Unit 1602-1603, 1 South Sathorn RD,
Yannawa, Bangkok. Thailand. 10120
Tel. +66-2-624-6730